

The Last Match

June 8 – 25, 2023

1st STAGE ■



1st Stage
With generous support from
BOOTSIE AND HUMO HUMENANSKY
Presents

The Last Match

WRITTEN BY
ANNA ZIEGLER

DIRECTED BY
ALEX LEVY

FEATURING

DREW KOPAS*
Tim

FABIOLLA DA SILVA
Galina

LYNETTE RATHNAM*
Mallory

CHLOE LATEULERE
Understudy

ETHAN MILLER
Sergei

PATRICK JOY
Understudy

PRODUCTION & DESIGN

SCENIC DESIGN
JESSICA ALEXANDRA CANCINO+

LIGHTING DESIGN
ALBERTO SEGARRA+

PROPS DESIGN
CINDY JACOBS

STAGE MANAGER
SARAH USARY

SOUND DESIGN
KENNY NEAL

ARTISTIC DIRECTOR
ALEX LEVY

DIALECT COACH
ADRIENNE NELSON

ASSOCIATE ARTISTIC DIRECTOR
DEIDRA LAWAN STARNES

COSTUME DESIGN
DANIELLE PRESTON+

ASSISTANT COSTUME DESIGN
COURTNEY JOHNSON

INTIMACY COORDINATOR
LORRAINE RESSEGER

This production is made possible in part by gifts from
our generous 1st Stage donors and with the support of



* Member of Actors' Equity Association, the Union of Professional Actors and Stage Managers in the United States, appearing under a Special Appearance Contract.

+ Member, United Scenic Artists, Local USA 829

THE PLAYWRIGHT



ANNA ZIEGLER is an award-winning playwright whose widely produced play *Photograph 51* won London's 2016 WhatsOnStage award for Best New Play. It was selected as a "Best of the Year" play by *The Chicago Tribune*, *The Washington Post* (twice) and *The Telegraph*.

In 2017, The Williamstown Theatre Festival, The Manhattan Theatre Club and The Geffen Playhouse premiered her play *Actually* (winner of the Ovation Award in Los Angeles for Playwriting of an Original Play), and The Roundabout Theatre Company produced *The Last*

Match. Her play *The Wanderers*, won the 2018 San Diego Critic's Circle Award for Outstanding New Play and *Boy* was nominated for the 2016 John Gassner Award by the Outer Critics Circle.

Her work has been produced on the West End (*Photograph 51*, starring Nicole Kidman, winner of the *Evening Standard* Award for Best Actress), at major theaters around the U.S. and in Australia, Japan, Italy, Germany, India, and Sweden. It's been developed at the Sundance Theatre Lab, The O'Neill Playwrights Conference, The Ojai Playwrights Conference, NY Stage & Film, Soho Rep, and the Cape Cod Theatre Project, amongst others.

She holds commissions from The Roundabout, Second Stage Theater, and Grove/Whitman Productions. She is developing television and movie projects with Paramount, Defiant by Nature, and Leviathan Productions.

Photograph 51 has been released as part of Bloomsbury's Modern Classics series. Bloomsbury/Oberon Books has published a collection of her work entitled *Anna Ziegler: Plays One*. *Anna Ziegler: Plays Two* is now out from Methuen Drama.

Anna is a graduate of Yale and holds Masters Degrees in Poetry from The University of East Anglia (UK) and Dramatic Writing from NYU.

DID YOU KNOW?

**1st Stage offers free 5 artist tickets each performance.
1st come, 1st serve. Our Artist Ticket program is generously
sponsored by Bootsie and Humo Humenansky.
Use the code **ARTIST** at check out to get your ticket!**

THE DIRECTOR



ALEX LEVY Alex has been the Artistic/Executive Director of 1st Stage since 2014. Alex's 1st Stage directing credits include *How the Light Gets In*, *The Phlebotomist*, *Secret Things*, *Trying*, *Columbinus*, the American premiere of *Hero's Welcome*, the world premiere of *Swimming with Whales* (6 Helen Hayes nominations including "Outstanding Director"), *The Farnsworth Invention* (6 Helen Hayes Nominations including "Outstanding Director"), *Jesus Hopped the 'A' Train* (winner of 2 Helen Hayes Awards and The BroadwayWorld Award for "Outstanding Production of a Play"),

the regional premiere of *Trevor* (2018 Helen Hayes nomination for "Outstanding Production of a Play"), *Lobby Hero* (named Best Regional Revival of 2016 by *The Wall Street Journal*), *Proof*, *The Good Counselor* (BroadwayWorld DC Award for "Best Director of a Play"). Since Alex joined 1st Stage, the company has won several awards including the American Theatre Wing's "National Theatre Company Grant" and was named "One of America's most impressive smaller theater companies" by *The Wall Street Journal*. Since Alex joined 1st Stage the company has won or been nominated for the Helen Hayes Award for "Outstanding Production" eight times. Before joining 1st Stage, Alex served as the Artistic Director of Ballybeg Theatre in New York City and Artistic Director of Pegasus Players in Chicago. In March 2017, his award-winning play *Safe at Home* was produced at Mixed Blood Theater at CHA Field, the home of the St. Paul Saints in St. Paul, Minnesota and was recently produced again at Tempe Diablo Stadium, the spring training facility of the Los Angeles Angels. Alex holds an MFA in Directing from The University of California-Los Angeles.

FAMILY PROGRAMMING in partnership with Arts on the Horizon

ARCO IRIS

World Premiere! Outdoors at Boro Park!

Created and Directed by Elena Velasco

June 29- July 1, 2023

Told through dance, movement and vibrant imagery, this production is drawn partly from the popular Zapoteca myth, as well as aspects of a Quechua legend about the rainbow (arco iris or iris). Iris, a young child, is about to go to el parque with Abuela. Iris has seven different colored shirts and must decide what to wear. Each "color" makes the case for itself, explaining their greater worth, and how each is seen and received by the world. For ages 3-6 and their families. All tickets are free and available at www.1stStage.org

*Presented with generous support from
Judye Groner, in memory of Ben Sappol*

THE CAST



FABIOLLA DA SILVA (GALINA) is a local actress, deviser, and teaching artist. She is absolutely thrilled to be making her 1st Stage debut! Select local credits: Prologue Theatre: *The Revolutionists* (Helen Hayes Award for Outstanding Supporting Performer), *World Builders*, The Kennedy Center: *Girl Power!*, Workhouse Arts Center: *Women Playing Hamlet*, We Happy Few: *La Llorona*, Adventure Theatre MTC: *Fantastagirl* and *the Math Monster* (Helen Hayes nominated for Best Ensemble), Folger Theatre: *Love's Labor's Lost*, Chesapeake Shakespeare Company: *Measure for Measure*, Convergence Theatre: Guerrilla Theatre Works: *A New Nation*. Films: *That Engagement Thing*, *The Importance of Finding the Other*, *Autumn's Room*. fabiolladasilva.com



DREW KOPAS (TIM) is overjoyed to return to 1st Stage where he was previously seen in *Airness* and *Italian American Reconciliation*. DMV: Woolly Mammoth Theatre Company, Everyman Theatre, Theater J, Folger Theatre, Constellation Theatre Company, Mosaic Theater Company, Olney Theatre Center, Shakespeare Theatre Company, Keegan Theatre, Rep Stage, Faction of Fools, We Happy Few, and the Capital Fringe Festival. Regional: Cleveland – Great Lakes Theatre, Dobama Theatre; Idaho Shakespeare Festival, Virginia Shakespeare Festival. MFA- Acting, Western Illinois University. DrewKopas.com



ETHAN MILLER (SERGEI) is thrilled to be returning for his second show at 1st Stage. Previously, he portrayed Owen in *Swimming with Whales* by Bob Bartlett; directed by Alex Levy. Other performances include: Derek in *A Measure of Cruelty* at 4615 Theater, *Demetrius* in *A Midsummer Night's Dream* at The Theater at Monmouth, and *Mike Mooney* in *Paint Your Wagon* at the Jackson Hole Playhouse. He is currently a member of the Drunk Shakespeare Society portraying M*cbeth and Macduff. Education: The University of Minnesota BFA Guthrie Actor Training Program.

THE CAST

LYNETTE RATHNAM (MALLORY) is thrilled to be back at 1st Stage! Regional credits include: *A Nice Indian Boy* (Olney Theatre Center); *Bars and Measures* (Mosaic Theater Company); *The Phlebotomist* (1st Stage); *It's Christmas, Carol!* (Oregon Shakespeare Festival); *A Wind in the Door* (Kennedy Center); *Kid Prince and Pablo* (Kennedy Center); *Shame 2.0* (Mosaic Theater Company); *4,380 Nights* (Signature Theatre); *Death of A Salesman* (Ford's Theatre); *Our War* (Arena Stage); *Mockingbird* (Kennedy Center); *When January Feels Like Summer* (Mosaic Theater Company); *The Trojan Women* (Taffety Punk); *The Fire and The Rain* (Constellation Theatre Company); *The Fantasticks* (Rep Stage); *Glassheart* (Rorschach); *Illyria, Julius Caesar* (Virginia Shakespeare Festival); *The Wings of Ikarus Jackson* (Kennedy Center); *A Midsummer Night's Dream, Twelfth Night, All's Well that Ends Well* (Maryland Shakespeare Festival); *In the Blood; Lyme Park* (The Hegira).



CHLOE LATEULERE (UNDERSTUDY) (She/Her) *The Last Match* is Chloe's first production with 1st Stage and she could not be more excited! Chloe is a graduate of Catholic University's Musical Theatre Program and a Signature Theatre's Overtures Alum. She was most recently seen in The Museum of the Bible's *The Heavens are Ringing* (Mary), CUA's *Caucasian Chalk Circle* (Grusha Vashnadze) *Suddenly Last Summer* (Mrs. Holly) and *Urinetown: The Musical* (Swing/Hot Blades Harry). She would like to thank the entire creative team for letting her be part of this project as well as her mom and Stefanos Tsitsipas for her love of tennis.



PATRICK JOY (UNDERSTUDY) (He/Him) is honored to be back here at 1st Stage, where he was last seen as Dylan Klebold in *columbinus* (Helen Hayes Nomination – Outstanding Lead Performer). Previous credits include Clitandre in *A Misanthrope* (WSC Avant Bard); Hal in *Proof* (Peter's Alley); John in *In the Closet* (Rainbow Theatre Project); Orestes in *Electra* (4615 Theatre Company); Trent Conway in *Six Degrees of Separation*, Jason in *Rabbit Hole* (Keegan Theatre); and more. And, he's very much looking forward to returning next season for *The Nance!* PatrickJoyActor.com



— THE PRODUCTION TEAM —

JESSICA ALEXANDRA CANCINO (Set Design) is a multidisciplinary Venezuelan artist, with a background in scenic design, scenic art, sculpture, and art installation. She explores how space sculpts our experiences and reframes stories to invite access to other's perspectives. Select design credits: *Secret Things*, *A Civil War Christmas*, *My Name is Asher Lev*, *Jesus Hopped the 'A' Train* (1st Stage), *Once on this Island* (Constellation Theatre Company), *A Chorus Within Her* (Theatre Alliance), Associate set designer with Beowulf Boritt – *Avaz* (South Coast Repertory), *Murder on the Orient Express* (Paper Mill Playhouse), *Fiddler on the Roof*, *in Yiddish* (New World Stages). Upcoming: *Amid Falling Walls* (National Yiddish Theatre). She is an inaugural recipient of the 1/52 Project grant. Helen Hayes nominee for outstanding Set Design in 2020 and Scenic Design Kenan Fellow at the Kennedy Center in 2016. USA829 Scenic Designer and Scenic Artist member based in NYC. www.jessicacancino.com

CINDY LANDRUM JACOBS (Properties Design) is happy to be working at 1st Stage again! 1st Stage credits include *How The Light Gets In*, *Airness*, *columbinus*, *A Civil War Christmas*, *Swimming With Whales*, *The Farnsworth Invention*, *Trevor*, *The Pitmen Painters*, and *Never The Sinner*. Additional Properties/Set Dressing Designer credits include: *Suessical*, *Lifespan Of A Fact*, *Elegies*, *The Outsider*, *Shakespeare In Love*, *Yoga Play*, *TransAM*, *N*, *Good People*, *Legally Blonde*, *God Of Carnage*, *The Undeniable Sound Of Right Now*, *Chicago*, *An Irish Carol* (2017-2022) and *Outside Mulingar* (The Keegan Theatre); *The Gentlemen's Exploration Club* (Prologue); *Letters To Juliet* (Urban Arias).

KENNY NEAL (Sound Design) is a Helen Hayes Award recipient (*The Royale* at Olney Theatre Center/1st Stage) and seven-time nominated sound designer, composer and arranger. DC AREA: 1st Stage (*The Last Match*, *Airness*, *columbinus*, *Jesus Hopped the 'A' Train*, *Well*, *Floyd Collins*, *Old Wicked Songs*, *Bat Boy*); Studio Theatre (*English*, *Straight White Men*, *Jumpers for Goalposts*, *Choir Boy*); Olney Theatre Center (*A Nice Indian Boy*, *Dance Nation*, *The Royale*, *Oil*); The Kennedy Center (*She a Gem*, *Digging Up Dessa*); Signature Theatre (*The Upstairs Department*, *Daphne's Dive*, *Easy Women Smoking Loose Cigarettes*, *Heisenberg*, *John*, *The Gulf*); Prologue Theatre (*Recent Tragic Events*); Constellation Theatre Company (*The Master and Margarita*); Theater Alliance (*Klytemnestra*); Factory 449 (*Agnes of God*); Taffety Punk (*Pramkicker*, *Mom Baby God*); as well as production for NextStop Theatre, WSC Avant Bard, The Welders, Rorschach Theatre, Imagination Stage, and Adventure Theatre MTC. EDUCATION: BA in Music History & Composition from St. Mary's College of Maryland.

ADRIENNE NELSON (Dialect Coach) AEA/SAG-AFTRA Adrienne co-starred on *House of Cards* (Chapter 29) as part of the Russian delegation and coached Lars Mikkelsen/PETROV (Russian dialect) during Seasons 3, 4, 5, and 6, coached the accent adjustments for Alexander Sokovikov/MORYAKOV for 5 episodes in Season 3 and helped coach the Russian for Patricia Clarkson in S6. She's also coached Russian dialects for Jewish Plays Project in NYC, Theater J, Adventure Theatre, University of Maryland's Graduate Opera Program, The Actors Salon and many wonderful individual actors. She played GRIGOR ANDOLOV'S (John Malkovich's) Russian Ex- Wife on *Billions* on Showtime in S3 and S4. For more coaching testimonials, VO, TV, Film, producing and teaching credits and reviews check out www.adrienne-nelson.com. On stage Adrienne has performed with Arena Stage, Theater Alliance, Martha's Vineyard, Rorschach Theatre, Forum Theatre, The Kennedy Center, Folger Theatre, SCENA Theater, Source Theater, Washington Shakespeare Company, Dublin's Performance Corporation, and Catalyst Theater. Adrienne was a Theatre Major/Russian Minor at Macalester College.

— THE PRODUCTION TEAM —

DANIELLE PRESTON (Costume Design) is a costume designer based in Washington, DC. 1st Stage Credits: *Jesus Hopped the 'A' Train*, *Hero's Welcome*, *The Farnsworth Invention*, *Fly By Night*, and *Civil War Christmas*. DC Credits: *Passing Strange* (Signature Theatre), *Clyde's* (Studio Theatre), *A Nice Indian Boy* and *The Joy That Carries You* (Olney Theatre), *One Jewish Boy* (Theater J), *The Till Trilogy* (Mosaic Theater). NYC Credits: *Where Words Once Were* (Lincoln Center). Regional Credits: *Locomotion* (Children's Theater Company), *Schoolgirls; Or The African Mean Girls Play* and *The Realness* (Hangar Theatre), *Fences* (Florida Rep Theater), *B.R.O.K.E.N. Code B.I.R.D. Switching* (Berkshire Theatre Group), *Quamino's Map* (Chicago Opera Theatre). Preston holds an M.F.A. in Costume Design from the University of North Carolina School of the Arts. She is a proud member of United Scenic Artists Local 829. daniellepreston.com On social media at [@daniellepres-tondesign](https://twitter.com/daniellepres-tondesign)

LORRAINE RESSEGGER-SLONE (Intimacy and Fight Director) (she/her) 1st Stage: *The Rainmaker*, *How the Light Gets In*, *The Phlebotomist*, *Secret Things*, *Ma Rainey's Black Bottom*. Baltimore Center Stage: *The Garden*, *How to Catch Creation*; Round House Theatre: *Spring Awakening*; Woolly Mammoth: *Describe the Night*, *BLKS*, *Botticelli in the Fire*, *Oedipus el Rey*, *Mr. Burns, a Post-Electric Play*; Shakespeare Theatre Company: *Much Ado About Nothing*, *Our Town*, *The Silent Woman*. Taffety Punk: *Pramkicker*. Taffety Punk Riot Grrrls: *Romeo and Juliet*, *Titus Andronicus*. Academy for Classical Acting: *Tis a Pity She's a Whore*, Theatre at Monmouth Summer Repertory 2022. Education—MFA: Virginia Commonwealth University.

ALBERTO SEGARRA (Lighting Designer) Recent selected DC credits include: *Passing Strange* at Signature Theatre; *Push The Button* at The Keegan Theatre; *Incognito* at Constellation Theatre; *Two Jews Walk into a War* at Theater J; *The Till Trilogy* at Mosaic Theatre; *Thanksgiving Play* and *The Joy that Carries You* (Helen Hayes Nomination for Outstanding Lighting Design) at Olney Theatre Center; *Acoustic Rooster*, *Beastgirl*, and *Earthrise* at The Kennedy Center TYA; *Quixote Nuevo* at Round House Theatre; *La Revoltosa* at GALA Theatre; *Blood at the Root* at Theater Alliance (Helen Hayes Award for Outstanding Lighting Design). Regional credits include: *The Great Leap* at The Hangar Theatre/Portland Stage; *The Three Musketeers* at Cleveland Play House; *1776* and *The Gift Horse* at New Repertory Theatre and *Priscilla, Queen of the Desert* at Blue Barn Theatre. Upcoming projects include: *Nate the Great at Imagination Stage*, and *Sweat* at Keegan Theatre. albertosegarra.com.

SARAH USARY (Stage Manager) is a stage manager based in northern Virginia and is excited to be back at 1st Stage! Previous credits—*The Member of the Wedding*, *Fly By Night*, *The Farnsworth Invention* (ASM), and *My Name is Asher Lev* (1st Stage); *Frankenstein*, *The Mountaintop*, *The Wolves*, *East of Eden* (NextStop Theatre Company); *She Kills Monsters* (Maryland Entertainment Group); *Assassins*, *Dracula* (Cumberland Theatre); *West Side Story* (SM), *Newsies*, *Mamma Mia!*, *Sweeney Todd*, *Little Shop of Horrors*, *My Fair Lady*, *The Pirates of Penzance* (ASM, Shenandoah Summer Music Theatre). Education—BFA Theatre Design and Production, Shenandoah University.

LOVE 1ST STAGE?

Volunteering is an incredible way to help the theatre and create community.
Join us as a volunteer at 1stStage.org/volunteer

— THE PRODUCTION TEAM —

DEIDRA LAWAN STARNES (Associate Artistic Director) is a theatre educator, performer, and director throughout the DMV. Her 1st Stage acting credits include *Mlima's Tale*, *Wanda's Way*, *The Mamalogues*, *The Member of the Wedding*, and *The Good Counselor*. Other regional credits include *The Hula Hoopin' Queen*, *The Amen Corner*, *Amadeus*, *Milk Like Sugar*, *The Gospel Of Loving-Kindness*, *Julius Caesar*, *Invisible Man* (Helen Hayes Award Most Outstanding Ensemble), *Intimate Apparel* (Helen Hayes Award), *A Raisin In The Sun*, *I Have Before Me A Remarkable Document....*, *Two Trains Running*, *Spunk*, *Twelve Days Of Christmas*, *Charlotte's Web*, *Passing Strange*, *In The Red And Brown Water*, *Radio Golf*, *King Lear*, *Doubt*, and *For Colored Girls Who Have Considered Suicide When The Rainbow Is Enuf*, Directed By Ntozake Shange. Film Credits Include *Chasing Refuge*, *Nocturnal Agony*, and *Ladder 49*. Directing Credits Include *The Rainmaker* (Helen Hayes Nomination For Most Outstanding Production), *A Civil War Christmas*, *Ma Rainey's Black Bottom* (Helen Hayes Nomination For Most Outstanding Production) (1st Stage); *Night Mother* (Anacostia Playhouse); *For Colored Girls Who Have Considered Suicide When The Rainbow Is Enuf* (Theater Alliance); *Street Life* and *The Name Game* (DC Theatre Festival); *Soul Collector* (Port City Playhouse); *Once On This Island, Jr.* and *101 Dalmatians* (The Theatre Lab Summer Musical Camp For Tweens). She Holds a BA in Theatre from the University of Maryland, an MFA in Drama from the University of Connecticut, and an MA in Producing Film, TV, and Video from American University. She is currently an Adjunct Professor at Bowie State University.

COURTNEY JOHNSON (Assistant Costume Design) is currently entering her senior year at Stevenson University where she is majoring in fashion design and minoring in real estate. She is currently interning for Danielle Preston for the summer as her costume design assistant. Although she is just beginning we expect more to come from Ms. Johnson.



TABLE TO STAGE 2023 THANK YOU RESTAURANT AND CORPORATE PARTNERS



A SPECIAL THANK YOU
TO THE PRODUCERS OF

The Last Match

**BOOTSIE AND HUMO
HUMENANSKY**



Bootsie and I have been long term tennis players and fans. As a matter of fact, we've attended all 4 grand slams as well as other major tournaments. Watching them involves sighs and cheers, smiles and frowns, and twists and turns.

No matter the outcome, they were exciting, pleasurable, and highly competitive. Once we understood the plot of *The Last Match*, we heartily agreed to produce the show to bring a little of the outdoor drama inside to 1st Stage.

BECOME A PRODUCER

Producerships give 1st Stage the foundation to take risks and offer the necessary resources to a production's creative team to realize their vision. It is a vital partnership that provides the opportunity to elevate the work to a higher level, bringing in the most talented artists and designers to create world-class theatre right here in Tysons.

**Interested in what it means to be a 1st Stage producer?
Contact Heidi Fortune Picker for details at heidifortune@1stStage.org**

2023-2024 SEASON



Logan Festival of Solo Performance July 13 to 23, 2023
This one-of-a-kind festival presents national, award-winning solo performers for two weeks of outstanding performances. The 2023 festival will feature the world premiere of 1st Stage's commissioned work **Stay, Run, Stay** written and performed by Khanisha Foster (*Joy Rebel*, 2019), **Mr. Yunioshi** written and performed by J. Elijah Cho (recipient of the "Best Solo Performance" at the 2019 Hollywood Fringe Festival), and **Not My First Pandemic**, written and performed by César Cadabes.

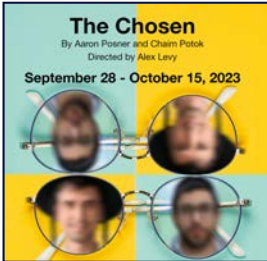

The Chosen, September 28 to October 15, 2023
Adapted by Aaron Posner and Chaim Potok from the novel by Chaim Potok.
Directed by Alex Levy.
Following a twice-extended run of *My Name is Asher Lev* in 2016— making it the most successful production in 1st Stage's history— 1st Stage brings another Aaron Posner and Chaim Potok adaptation to the region. Adapted from the well-loved novel, this critically acclaimed play takes us on a journey with two young Jewish boys as they navigate the complexities of their relationships with each other, their families, and their religion. Set against the backdrop of 1940s Brooklyn, *The Chosen* is a timeless story about the universal struggles of growing up and finding one's place in the world. "This production richly engages its audience in a broad range of topics, including the nature of friendship." - *Los Angeles Times*

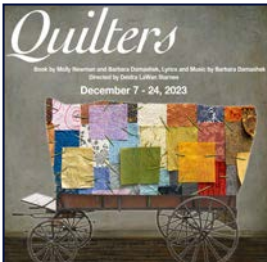

Quilters, December 7 to 24, 2023
Book by Molly Newman and Barbara Damashek with lyrics and music by Barbara Damashek.
Directed by Deidra LaWan Starnes.
Set on the American frontier, this moving musical tells the story of a group of women who come together to create a quilt that reflects their shared history, struggles, and triumphs. The story blends a series of interrelated scenes into a rich mosaic which captures the sweep and beauty, the terror and joy, the harsh challenge and abiding rewards of frontier life. With soaring harmonies, touching monologues, and stunning choreography, *Quilters* is a musical experience unlike any other.

"*Quilters* is a show pieced together with love and stitched with pride...a thing of beauty, comfort and joy." - *New York Post*



The Lake Effect, February 1 to 18, 2024
By Rajiv Joseph.
Directed by Alex Levy.
A drama of family secrets by Pulitzer Prize finalist Rajiv Joseph. During a fierce Cleveland mid-winter storm, estranged siblings are reunited by their father's sudden death. In the midst of closing his failing Indian restaurant, they must confront the painful memories and secrets that drove them apart. With witty dialogue, richly drawn characters, and a deep understanding of the complexities of human relationships, *The Lake Effect* is a must-see.
"Simply brilliant." - *Showbiz Chicago*

—2023-2024 SEASON—



The Nance, April 4 to 21, 2024

By Douglas Carter Beane.

Directed by Nick Olcott.

This witty, Tony Award-Nominated play, filled with music, dance, and comedy sketches, introduces us to Chauncey Miles, a gay burlesque performer at the Irving Place Theater. *The Nance* recreates the naughty, raucous world of burlesque's heyday and tells the backstage story of Chauncey and his fellow performers. At a time when it was easy to play gay and dangerous to be gay, Chauncey's uproarious antics

on the stage stand out in marked contrast to his offstage life. A "funny but bittersweet portrait of a vanished era". -The Chicago Tribune



June 2024

Stay tuned for more information about what is coming to 1st Stage in June 2024!

**SUBSCRIBE TODAY AT THE BOX OFFICE OR VISIT
WWW.1STSTAGE.ORG/SUBSCRIPTIONS**



Deborah Ford Larson

Long and Foster Realtors

Specializing in Northern Virginia Properties since 1975

Also licensed in Sanibel and Captiva Islands, FL

CELL/TEXT: 703-966-9474

EMAIL: deborah.larson@longandfoster.com or sales@debbiehouses.com

Visit my website: www.debbiehouses.com It will make you smile!

—SUBSCRIBE AND SAVE—



- ✓ Invest in 1st Stage as a subscriber.
- ✓ Reserve your seat for the full season.
- ✓ Save up to 50% on single tickets.

Most importantly, you are **committing to artists, shared experiences, communication and conversation, and the celebration of the stories that both reflect and challenge our ideas.** All Subscriptions and Flex Passes include exclusive invitations to Opening Night Receptions and special events.

Find the package that works best for you!

PREMIERE SUBSCRIPTION

DUAL= \$360, SINGLE= \$180

Includes a ticket for each mainstage show, a festival pass for the Logan Festival of Solo Performance, plus an additional “bring a friend” pass.

Deepest Savings! – Save over 40% on season tickets and a Solo Festival Pass by becoming a Premier Subscriber!

MILITARY/EDUCATOR PREMIERE SUBSCRIPTION

DUAL= \$240, SINGLE= \$120

All the benefits of the Premier Subscription at deep discount for military (active or retired)/ educators.

Includes a ticket for each mainstage show, a festival pass for the Logan Festival of Solo Performance, a guest pass, and invitations to exclusive Opening Night receptions and special events.

FLEX PASS

Starts at \$100

The versatile Flex Pass gives you a specific number of tickets to use anytime throughout the season. You can use all of your tickets at once, singularly, or in groups. It's up to you! You can even give the passes as gifts for birthdays, celebrations, or at the Holidays!

Save money – The Flex Pass will save you over 30% on season tickets.

Be choosy – One of the plays in the season not speaking to you? You can choose to skip it and use your Flex Pass tickets on the shows that excite you this season. There's a lot to choose from and explore!

CLASSIC SUBSCRIPTION

DUAL= \$300, SINGLE= \$150

Includes a ticket for each mainstage show plus an additional “bring a friend” pass.

Save money – Your Classic Subscription saves you 40%! That's still over a 35% discount at the senior rate.

3-PLAY SUBSCRIPTION

DUAL= \$200, SINGLE= \$100

Not interested in every play? This option is for you! Includes a ticket for three shows (of your choosing) plus an additional “bring a friend” pass.

Save money – Your 3-Play Subscription saves you over 40%! That's still over a 35% discount at the senior rate.

SUSTAINERS

Love seeing a show more than once?
Don't want to be locked into a specific season?

Become a Member and see as many shows as you want,
as many times as you'd like!

COMPANY MEMBER

\$200/year (auto-renews every 12 months)

Use your Company membership to purchase a \$35 companion ticket to 1st Stage.

SUSTAINER

\$20/month (auto-renews each month)

Use your Sustainer membership to purchase a \$20 companion ticket to 1st Stage.

HELP 1ST STAGE THRIVE! ADD A MONTHLY TAX-DEDUCTIBLE GIFT!

SUPER SUSTAINER

\$50/month (auto-renews each month)

Sustainer plus \$30 per month tax-deductible gift to 1st Stage.

SENSATIONAL SUSTAINER

\$70/month (auto-renews each month)

Sustainer plus \$50 per month tax-deductible gift to 1st Stage.

STUNNING SUSTAINER

\$120/month (auto-renews each month)

Sustainer plus \$100 per month tax-deductible gift to 1st Stage.

Stunning Sustainers are invited to Sunday Socials.

PHENOMENAL SUSTAINER

\$1020/month (auto-renews each month)

Sustainer plus \$1000 per month tax-deductible gift to 1st Stage.

Phenomenal Sustainers are invited to Sunday Socials and have the opportunity to become a producer.

YES PASS

YES PASS

The Youth Engagement Subscription (YES Pass) is a **free 1st Stage season subscription** for high school students in Fairfax County.

1st Stage believes that all young people should have the opportunity to be a part of the conversation and the artistic life of Fairfax County.

**SUBSCRIBE TODAY AT THE BOX OFFICE OR VISIT
WWW.1STSTAGE.ORG/SUBSCRIPTIONS**

IN THE GALLERY MICHELLE SIMONEAUX



Conceptually my work is structured around the idea of association and meaning, it is the filling between the present and the past, the link between unregulated responses and problem-solving stages. The terrain for this type of exploration is varied as I like to probe various media and techniques to uncover what they have to offer. Being surprised by what appears at different stages is an important building block of my process. The gradual construction of the object is realized through a series of layers, each resulting from the interplay between stimulus responses and image creation. Within this conceptual framework, I produce self-contained universes of light and movement. Whether on a static surface or a moving platform, I depict worlds evocative of a milieu that is both familiar and strange, at times capable of eliciting contemplation and elusive emotions

Gallery Curator: Deborah Conn, deborahconn@verizon.net



Tysons Realty Inc.

PAULINE THOMPSON

Founder, President, CEO

8321 Old Courthouse Road -140
Tysons Corner, VA 22182

Off. 703-893-5700
Cell: 703-599-1488
Fax: 703-893-6859

EM: TYSONSREALTY@AOL.COM

Retail, Office, Industrial, Apts. Asset Mgt.

OUR PROMISE: GREAT THEATRE

We hope you will consider a donation to further the work 1st Stage does for our community. Our reality is that ticket sales only account for half of our revenue. The other 50% comes from generous donors like you. Please consider a contribution that will allow 1st Stage to continue providing the magic of theatre to you. Thank you for being a part of the 1st Stage family. We are honored to have you here.

Please, stop by the box office desk to make your contribution or send a check to PO Box 9384, Tysons, VA 22102.

PROJECTED
OPENING
2024

defy expectations.

DISCOVER LUXURY OF A DIFFERENT KIND

Introducing The Mather in Tysons, Virginia—
a forward-thinking destination for those 62
and better.

Forget what you thought you knew about
senior living. Inquire today.

(703) 348.8522 | themathertysonson.com

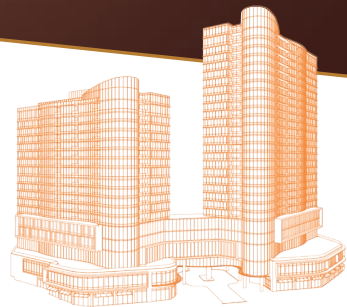

the
mather

Delight • Revel • Aspire



3/22 PB 357

THANK YOU OUR DONORS

(June 1, 2022 – May 31, 2023)

Thank you to all who make our work possible.

\$30,000 and above

Elizabeth R. Benson
Martha and
John McGrane
Kay Rzaasa and
Deb Crierie
Margaret Sheeran and
Tom Manteuffel
Jack Wilbern and
Patricia Tetro

\$15,000-\$29,999

Anonymous
Jacqueline Cookston and
Anne Nolan
John and Patricia Dyer
Howard and Elaine Forman
John and Meg Hauge
Bootsie and
Humo Humenansky
Sandy Laeser
Kathleen Gilles Seidel

\$10,000-\$14,999

Eleanor and
Richard Bochner
Judy Groner
Matt Korn and Cindy Miller
Susan and Donald Levy
Eileen Mandell

\$5,000-\$9,999

Anonymous
Marjorie and
Scott George
Theodore Gold and
Margaret Gering
Thomas Goodwin and
Cheryl Mathis
Kathleen and
Anthony LaBarbera
Mike and Tara Levy
Doug and Diane Lovejoy
Kathy Maher
William Newman and
Sheila Johnson
Adrienne and Ed Schmitz

\$2,500-\$4,999

Judy Jobbitt and
Thomas Marshall
Lynne and Robert Ketcham
Alex Levy
Alan McAdams and
Ellen Dykes
Doug and
Diana Pinkham
Joseph Warin and
Julie Lansaw Warin
Rochelle Zohn

\$1,000-\$2,499

Anonymous (3)
Donald Adams and
Ellen Maland
Gene and Pam Bacher
Laura Bromberg and
Robert Martin
Carol Caparosa
José Carrasquillo
Barbara Carroll and
Jon Picker
Robert Cookston
Terrie Hauck
Dori Hazan
Robert Hebda

Gail and John Howell
Marty and Bonnie Hurwitz
Lois Ireland and
Pierre Huggins
Chidi and Faith James
Jane and Brad Kalbfeld
Renee Klish
Hannah and Chuck Lefton
Peter Lewis
Adrian and Marcia Lund
Wes MacAdam
Debbie Massey
Ronald and Ellen Neubauer
Katie Newland
Melissa and
Gene Nicholson
John Perry and
Jeff Mintzer
David and Joy Peyton
Thomas Pierce and
Lu Ann Dillon
Carol and Doug Powell
Ray Saulino and
Debbie Cerulli
Lynne and
Bobby Silverstein
Barry Sullivan and
Alan Scott
Denny and Jan Towers
Janet and John Tysse
Paul and Katie Westpheling
Renee Yuengling

\$500-\$999

Anonymous (2)
Caren Anton
Lunette Arledge
Lori and Paul Carbonneau
Bonnie Carroll and
Roy Cooper
Ed Comer
Deborah Conn and
Howard Cincotta
Stephen Cruze
Tim and Anna Donaldson
Amy and Bo Duma
Linda Gehr
Virginia Geoffrey and
John Andelin
Bob Guberman
David Hindin and
Sally Bloomberg
Barry Holt and
Julie Samuels
Dr. Sari Hornstein
Bonnie Kawecki
James and Jean Keeney
Keith and Bari Livingston
Ben, Dorrit, and
Asher Lowsen
Ann Makowski
Maureen and
Richard Mercier
Daniel and Judith Mills
Marsha Mofson and
Jeff Dannick
Marcela Montes
Ilga Pakalins
Craig Pascal
Carol and Doug Powell
Wilma Probst
Karen Pyeatt
Wayne and
Marcy Rehberger

Jeffrey and
Daniele Robbins
Mark and
Donna Samblanet
Nigel and Linda Smyth
Carlos Velazquez
Linda Young
and Steve Sibener
\$250-\$499
Paul and Nancy Allard
John and Patricia Ball
Michael and Lissa Barry
Sabra Benson
Shirley and
Dennis Bloomquist
Joan Botuck
Lauren and Jason Brennan
Sandra Buratti
Mark and Cynthia Carter
Susan Christie
Linda and John Cogdill
Carolyn and Ladd Connell
Janet and Bill DuBose
Dave and Loraee Durbin
Chris and Angela Ehemann
Uma Ferrell
Nancy Finken
Lawrence Franks and
Ellen Berelson
Mark and
Diana Fredenburg
Gerald Gleason and
Naomi Robin
Bob Guberman
Gregory and
Joy Hildeman
Thomas Holzman and
Alison Drucker
Nancy Hopkins
Lisa Hoskins
William and Debbi Iwig
Caleen and Carl Jennings
Sherry Joslin
John and Bracha Laster
T. Michael Louden
Marcela Montes
Paul Nicholas
Phil and
Chris Niedzielski-Eichner
Stan Peabody
Rebecca Perez
Heidi and Ari Picker
Nancy and Saul Pilchen
Sue and Jim Price
Roz Rakoff
Mark and Ginni Richards
Diane Rosacker
Rosemary Schwartzbard
Jim and Beverly Seacord
Allan Shapiro and
Jaye Helferd
Patricia and
Robert Silverman
Sam and Susan Simon
Michelle Simoneau
Mike and Leigh Sneed
Lloyd Starns
Allison Stockman
Patricia and Bruce Vaughn
Karen and
Michael Weinberger
Christine and
Ken Westbrook

Barbara and John Wille

\$100-\$249

Anonymous (14)
Mary Ann Allin
Susan Altfeld and
Lee Gorsky
Susan and George Amato
Rekha and Craig Arness
Nicole and Nate Baldwin
Jessica Balick
The Ballard Family
Charlie Barnett
Micheale Battles
Barbara Bear
Bill and Fern Bekenstein
Dottie Bennett
George and Gail Bergquist
Sheila Billingsley
John and Cindy Blakeley
Edmund and
Dolores Bujalski
Dominique Callins
Michael and
Napapan Carpenter
Diane Carroad
Phyllis Cela and Gary Sidell
Eric and Diana Chafetz
Robert Cheek
Barbara and Douglas Cobb
Ray Colangelo and
Ilene Gast
Barbara Tragakis Conner
Louise K. Crane
Isabelle Cummings
Bernard DeLeo and
Rebecca Hill
Lynda and Larry Dentler
Melanie and
James Douglas
Charles and Eileen Duggan
Amy and Bo Duma
Diane Fairchild
Andrea Field
Carole and Barry Forman
Amanda Forstrom
Tom and Jenny Fortune
Dagne Fulcher
Eleanora Gafton
Stephen Gold and
Wini Atlas
Nadja Golding
Gailmarie Goldrick
Diane Gorman
Gabe Greene and
Mia Fiorella
Peter Grey
Jonathan Groisser and
Hana Newcomb
Gail Gulliksen
Jim and Julie Hamilton
Thomas Harter
Barbara Hawthorn
Richard Haynes
Susan Hennessy
Jack and
Arlene Hermansen
Marie Himel and
John Butler
Elizabeth Jablin
Barbara J. Jacob and
Douglas Kleine

THANK YOU OUR DONORS

(June 1, 2022 – May 31, 2023)

Thank you to all who make our work possible.

\$100-\$249 continued

Caren Kamberg and
Michael Kosecoff
Susan Kamener and
Brian Murphy
Katherine and
Robert Kroehler
Eileen Lawrence and
Robert Greenfield
LuAnn and Len Levitt
Jon, Christy, Daniel, and
Ellie Levy
Erik and Schana Levy
Roman and Beth Lewycky
Nancy Limprecht and
Rick Haines
Michael Lipsky and
Mariette Newcomb
Sailini and Sandeep Lohia
Judith Macon
Marty and Donna Malarkey
Madeline and
Gerald Malovany
Ron and Jenny Mancus

John and Karen Mansfield
Stella Matalas
Sandy McKenzie
Jennifer Mendenhall and
Michael Kramer
Mable Mestre
Janet Minkler
Nell Minow and
David Apatoff
Lyn Moen
Kristin Moyer
Jasper Napoli
Kathy and Reed Nibley
Ruth and
John Nowjack-Raymer
Yvonne Paretzky
James and
Susan Pittleman
Terry Quist
Roz Rakoff
Terri and Donald Rea
Steven and
Pamela Rearden
Norma Jean Reck

Donna and Bill Reinhold
Richard Yeates Richards
Edward and
Cherise Robinson
Victoria Robinson
Gay Rogers
Neal and Laura Romstedt
Robert Rosenberg and
Mary Ann Kennedy
Gail Rosner
Lucia Rothman-Denes
Suzanne Rothwell
Mary Rouvelas
Elise Ruedi
Jean Schreier and
Margarita Lopez
Sandra and David Sellers
Debbie Shatz
Ellen and David Sher
Lucienne and
Henry Skopek
Lisa Sockett and
Andrew Joskow
Jolanda Spata

Steven Spayd
Sheri Stroud
Mary Szpanka
David and Susan Talley
Ilene and
Stan Trachtenberg
Amparo Trujillo
Martha Trunk
Brian Wallace and
Amy Walker
Andrea Wallen
Lydia Walker
Chris, Patty, and
Sean Westra
Michael Westra
The Wille Family
Gregory Williams
John Wilson
Gail and Chris Wollenberg
Romnet Wright and
Paul Cohen
Joan Zeigler
Laura Zimmerman

CORPORATE & FOUNDATION

American Theatre Wing
ARTSFAIRFAX
Arts Forward Fund
Bazin's on Church
Boeing Company
BOWA
Bright Funds Foundation
bwdarchitects
BDO
Caplin Foundation
Catalogue for Philanthropy
Compass Pro Bono
Clarity
Elderberry Cottages Company
Ekko Title
Five Star Bank
Exxon Mobil Foundation
The Georgelas Group
Goldman, Sachs and Co.
Google, Inc.
Greenwich Group International

Harris Design, Inc.
HBC Group/KW
India Hicks
HMA Associates, Inc.
International Monetary Fund
Kositzka, Wicks and Company
The Ruth and Hal Lauanders
Charitable Trust
The David and Reva Logan
Foundation
LS Technologies, LLC
The Mather Tysons
McLean Community Foundation
The Meridian Group
The Morgan Fund
The Morningstar Foundation
The National Endowment for the Arts
The Neal Team
Nostos
Paul French Bakery & Café
Pillar to Post

Pulcinella
M. Raina Associates
Rappaport Management Company
RBC Wealth Management
ReFrame Wealth
The Reinsch Pierce
Family Foundation
The Revada Foundation
The Ross Roberts Fund,
The Community Foundation
of Northern Virginia
Seasons 52
The Share Fund
The Shubert Foundation
The Sumac Foundation
Summit Community Bank
Sweet 120, LLC
Virginia Commission for the Arts
Walsh, Colucci, Lubeley and Walsh
YourCause, LLC

In addition to offering **CAPTIONING** and **AUDIO DESCRIPTION** for selected performances throughout the season,
1st Stage now offers ASSISTIVE LISTENING DEVICES for all performances.

CAPTIONED and AUDIO-DESCRIBED PERFORMANCES



Open Captioned Performances
All performances June 15 - 18

Audio Described Performance
Sunday, June 25 at 2pm



ASSISTIVE LISTENING DEVICES

Assistive Listening Devices (ALDs) are available at every performance. Please request services at the box office when you check in.

Accessibility services are made possible through the generous support of the McLean Community Foundation and ARTSFAIRFAX.

THANK YOU OUR DONORS

(June 1, 2022 – May 31, 2023)

Thank you to all who make our work possible.

PRIME SQUARE FEET

“Prime Square Feet” are highly visible markers of your generous support for 1st Stage. To purchase “Prime Square Feet” in the theatre contact Heidi Fortune Picker at heidifortune@1stStage.org.

Office – Kate Levy
Lobby – Kathleen Gilles Seidel
Stage – LS Technologies LLC

Hallway Wall – Mark Krikstan
Hallway Wall – Deb Crerie
Hallway Wall – Jane Margulies Kalbfeld

Reception and Hallways

In Honor of Dick Laeser
In Memory of Steve A. Mandell
In Memory of Quin Mulcahy Kaweck
In Memory of Ben Saypol
ARTSFAIRFAX
Elizabeth Benson
Mark and Cindy Carter
John and Meg Hauge
Bootsie and Humo
Edmund and Dee Bujalski
bwdarchitects
Jacqueline Cookston
Patty Dyer
Elderberry Cottages Company
Howard and Elaine Forman
Scott and Marjorie George
Theodore Gold and Margaret Gering
Toni Harrington and Ed Sumner

Harris Design, Inc.
Holly Hassett
Thomas Goodwin and
Mary Cheryl Matheis
Lynne and Robert Ketcham
Matt Korn and Cindy Miller
Kathleen and Anthony LaBarbera
Susan and Donald Levy
Doug and Diane Lovejoy
The Ruth and Hal Lauenders
Charitable Trust
Kathy Maher
Tom Manteuffel and
Margaret Sheeran
The Mather Tysons
Martha and John McGrane
McLean Community Foundation

The Morgan Fund of the
Seattle Foundation
The National Endowment for the Arts
Paul French Bakery & Café
RBC Wealth Management
ReFrame Wealth
Reinsch Companies
The Reinsch Pierce Foundation
The Revada Foundation
Raymond Saulino and Debbie Cerulli
The Share Fund
The Shubert Foundation
Linda Smyth
Virginia Commission for the Arts
Kathie and Paul Westpheling
Jack Wilbern and Patricia Tetro
Rochelle Zohn

Every effort has been made to ensure that donor lists are accurate. If you name is misspelled or omitted, please accept our apologies and inform 1st Stage at (703) 854-1856 or email the theatre at boxoffice@1stStage.org.

PAUL
FRENCH BAKERY & CAFÉ

Now for the
ENCORE



Proud supporters of
1st STAGE ■

www.pauldmv.com

1ST STAGE

BOARD OF DIRECTORS

Chair

Jack Wilbern

Secretary

Jacqueline A. Cookston

Treasurer

Tom Manteuffel

Elizabeth R. Benson
Dominique Callins
Howard J. Forman
Chidi I. James
Judith Marshall Jobbitt
Anthony G. LaBarbera
Douglas C. Lovejoy
Martha B. McGrane
William T. Newman, Jr.

1st STAGE ARTISTIC ASSOCIATES

Debra Crerie - Designer
Kathryn Kawecki - Designer
Jessica Lefkow - Actor/Director
Kay Rzasa - Designer
Deidra LaWan Starnes - Actor/Director
Jacob Yeh - Actor

1st STAGE FOUNDING ARTISTIC DIRECTOR

Mark Krikstan

1st STAGE FOUNDING ARTISTS

Lucas Beck
Deb Crerie
Jane Margulies Kalbfeld
Nathaniel Krause
Alex Mandell
Peter Van Valkenburgh
David Winkler
Cheryl Patton Wu

SPECIAL THANKS FOR THEIR ASSISTANCE WITH THIS PRODUCTION

Arlington Scene Shop
Jared Davis
Andrew Reilly
Edward Wiant
David Teitelbaum
John Perry
Joe Chuckran
Michele Krisanda
Craig Hardenbergh

STAFF

Artistic/Executive Director

Alex Levy

Associate Producer

Emily Wall

Director of Engagement

Heidi Fortune Picker

Associate Artistic Director

Deidra LaWan Starnes

Director of Community Relations

Eileen Mandell

Casting Director Emeritus

Jane Margulies Kalbfeld

Web and Media Director

Robin Harris, Harris Design Inc.

Technical Director

Jack Beckey

Connectivity Director

Audra Jacobs

Box Office Associates

Zoe Harr
Sonia Hossain
Kathryn Starnes

TECHNICAL CREW

Electricians

Kat Darnell
Moki

Indigo Garcia
Sarah Velkovich

Carpenter

John David Wilson

Scenic Charge

Blake Mihm

Painter

Fred Via

1st STAGE THEATRE

Architects

Butz-Wilbern, Ltd.

General Contractor

M. Raina Associates

1st
STAGE 

1st Stage

1524 Spring Hill Road
Tysons, VA 22102
1stStage.org • (703) 854-1856